

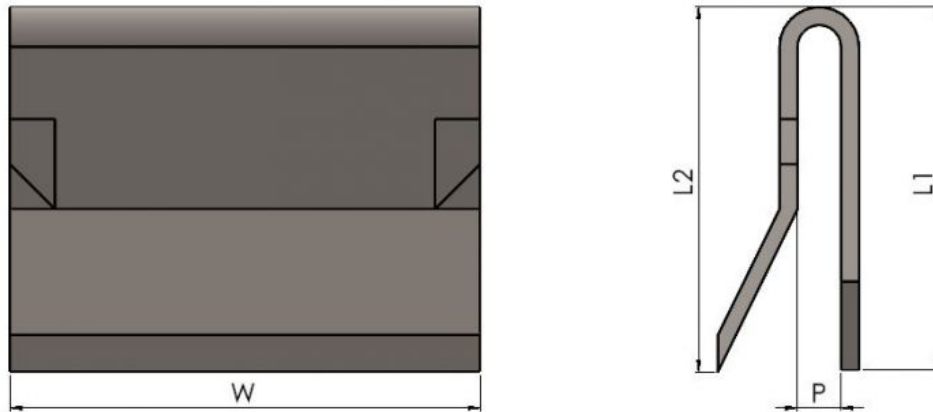

Series: 40503 Type: D



## D Type Edge Clip

Part No.	Panel Range	Dim. L1	Dim. L2	Dim. W
13020	0.6 - 1.2	8.7	8.7	12.7
16220	1.0 - 3.6	11.0	11.0	12.7
13210	0.9 - 1.6	8.7	8.7	12.7
14360	1.8 - 2.4	8.7	8.7	12.7
14620	1.8 - 3.2	12.7	12.7	12.7
15220	2.6 - 2.8	7.9	7.9	12.7
16460	2.2 - 3.2	8.7	8.7	12.7
24680	4.2 - 5.1	10.3	10.3	12.7
13220	5.4 - 5.6	10.3	14.3	12.7

D Type Edge Clips are quick fit versatile fasteners, available in a wide selection of panel ranges to satisfy any conceivable application. Their primary function was to secure cloth or leather trim to panels whilst displaying an acceptable finish on the cloth side should they remain visible in the application. The fact that there are no barbs on the D side ensures that it fits almost flush with the panel providing a neat appearance.

Material: Spring Steel    Finish: Black Phosphate or Trivalent Zinc

**All information is given for guidance only and designers should satisfy themselves as to the suitability of the specification by requesting samples**