

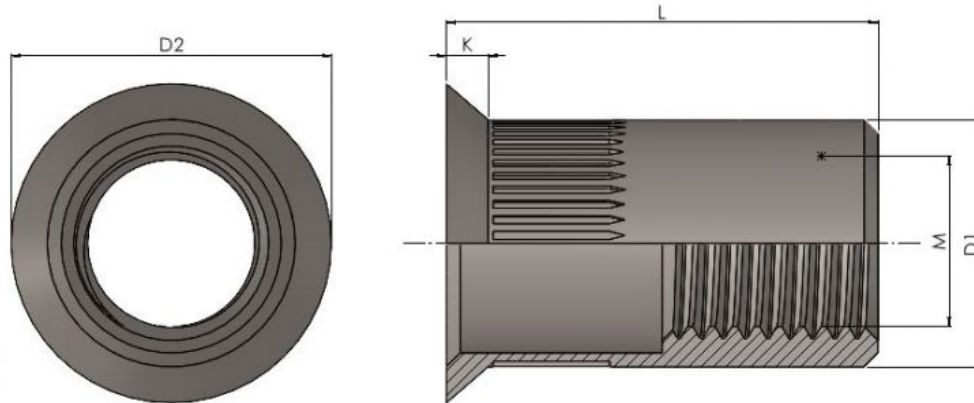

Series: 30208 Type: CS Steel



## Rivet Nut Countersunk Head Round Body

Part No	Thread M	Grip Range	Hole Size	D1	D2	K	L
CS03-1	M3	1.5-3.5	5.0	4.9	7.5	1.5	11.5
CS04-1	M4	1.5-3.5	6.0	5.9	8.5	1.5	12.0
CS05-1	M5	1.5-4.0	7.0	6.9	9.5	1.5	13.0
CS06-1	M6	1.5-4.0	9.0	8.9	11.5	1.5	15.5
CS08-1	M8	1.7-4.5	11.0	10.9	13.5	1.5	23.5
CS10-1	M10	2.0-4.5	12.0	11.9	14.5	1.7	21.0

Countersunk Rivet Nuts provide a stronger flush head when used with countersunk holes. The knurled body provides extra torque resistance.

Materials and Finishes (Code):  
 Steel, Trivalent Zinc (60)

**All information is given for guidance only and designers should satisfy themselves as to the suitability of the specification by requesting samples**