

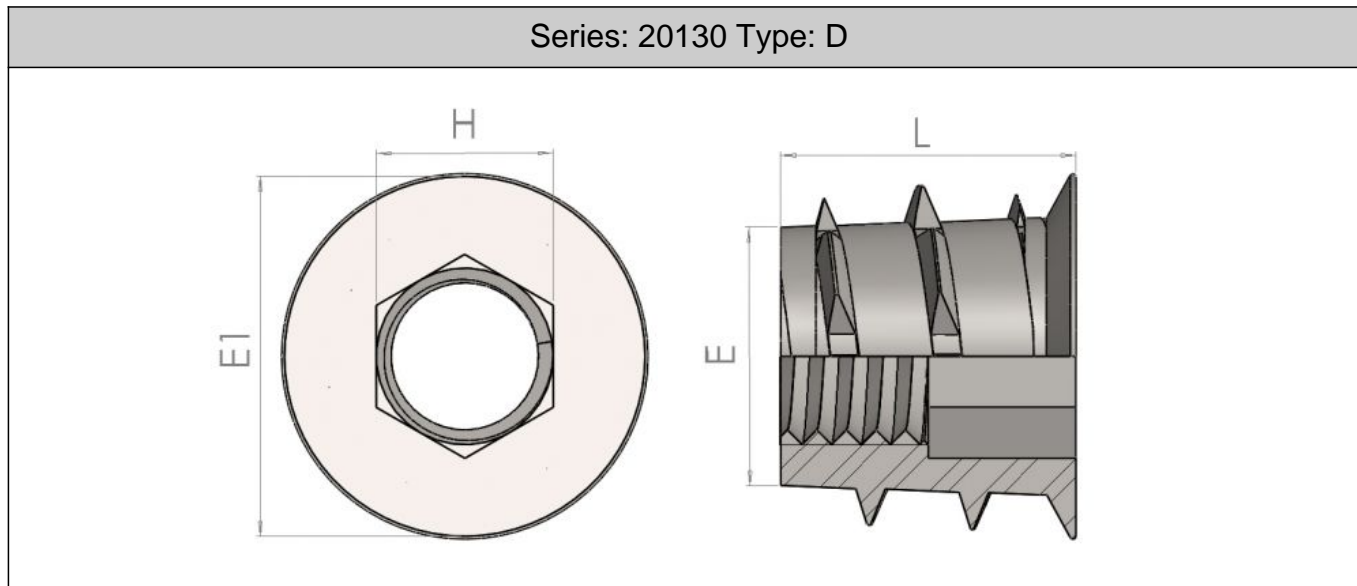

Series: 20130 Type: D



Woodcert With Head Type D

Part No.	Thread	L	Hole	E	E1	H
M410	M4	10	5.7 / 6.0	5.5	7.8	4.0
M507	M5	7	7.7 / 8.0	7.1	11.5	5.0
M510	M5	10	7.7 / 8.0	7.1	11.5	5.0
M513	M5	13	7.7 / 8.0	6.6	11.5	5.0
M520	M5	20	7.7 / 8.0	7.0	11.5	5.0
M610	M6	10	8.7 / 9.0	8.0	12.5	6.0
M613	M6	13	8.7 / 9.0	7.5	12.5	6.0
M616	M6	16	8.7 / 9.0	7.5	12.5	6.0
M620	M6	20	8.7 / 9.0	7.5	12.5	6.0
M625	M6	25	8.7 / 9.0	8.0	12.5	6.0
M813	M8	13	10.7 / 11.0	9.5	14.5	8.0
M820	M8	20	10.7 / 11.0	9.5	14.5	8.0
M825	M8	25	10.7 / 11.0	9.5	14.5	8.0
M1013	M10	13	12.2 / 12.25	11.5	16.0	10.0
M1025	M10	25	12.2 / 12.25	11.5	16.0	10.0

Woodcert inserts offer a very strong fixing into soft wood and composite materials. They are installed by screwing them into the parent material using a hexagon driver or allen key. The thin flange sinks flush with the substrate and provides a larger mounting surface area. Common applications include furniture, shopfitting and rotational mouldings. Material and Finishes:-Zamac Zinc Clear (Code 60) Zamac Zinc Yellow (Code 40)
 To Specify Use: Series No / Part No / Finish Code (eg 20130 M510 60)

All information is given for guidance only and designers should satisfy themselves as to the suitability of the specification by requesting samples