

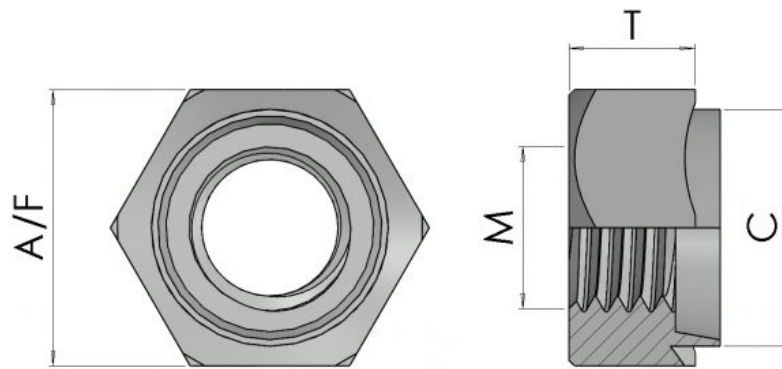

Series: 30108 Type: HEX



## Hexagon Rivet Bushes

Part No.	Thread	Hole Size+0.5-0	A/F E +/- 0.13	Body T+/-0.13	Skirt C/+0-0.13
M25??HEX	M2.5	5.54	7.92	3.17	5.54
M3??HEX	M3	5.54	7.92	3.17	5.54
M35??HEX	M3.5	6.73	7.92	3.17	6.73
M4??HEX	M4	6.73	7.92	3.17	6.73
M5??HEX	M5	7.92	9.52	3.81	7.92
M6??HEX	M6	9.52	11.10	5.08	9.52
M8??HEX	M8	12.70	14.27	6.35	12.70
M10??HEX	M10	15.87	19.05	7.62	15.87
M12??HEX	M12	19.05	22.22	10.16	19.05

Legend	
*	Usually Available from Stock
**	Non-preferred (Possible Lead Times)
***	Special Order Only

SWG/MM	M2.5	M3	M3.5	M4	M5	M6	M8	M10	M12
8G/4.0	***	***	***	***	***	***	***	**	**
10G/3.2	***	**	**	**	**	*	*	*	*
12G/2.5	***	**	**	**	*	*	*	*	*
14G/2.0	***	*	**	*	*	*	*	*	*
16G/1.6	*	*	**	*	*	*	*	**	**
18G/1.2	***	*	**	*	*	*	*	**	***



Continued from previous page...

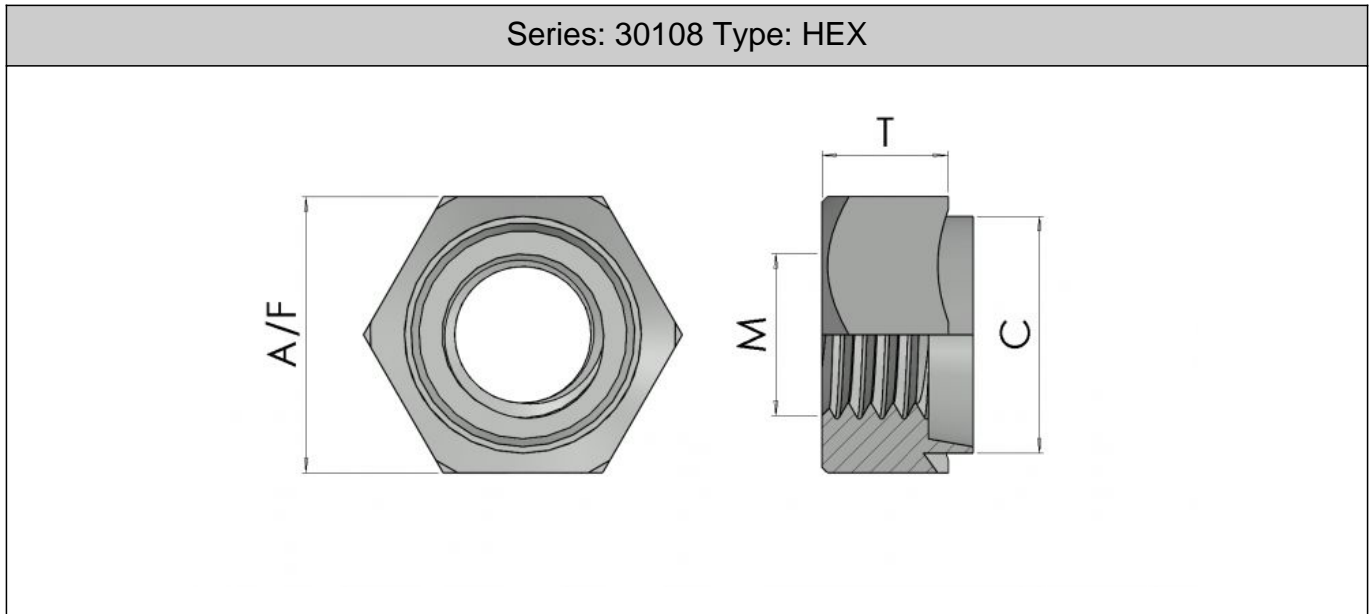

20G/1.0	***	*	**	*	*	**	**	***	***
---------	-----	---	----	---	---	----	----	-----	-----

Hexagon Rivet Bushes provide a strong female thread in sheet metal. The spigot is placed through a pre-punched hole and riveted on the reverse side, the corners of the hex bar bite into the sheet providing excellent torque resistance. Various spigot lengths are available for different sheet thicknesses.

Materials & Finishes:-Steel Solf Colour (Code 2)Steel Trivalent Zinc (Code 26)303 Stainless Steel (Code SS)

To Specify Use Serie No / Part No / Material Size / Finish Code (eg 30108 M416 HEX26)

Prefered Sizes

**All information is given for guidance only and designers should satisfy themselves as to the suitability of the specification by requesting samples**