

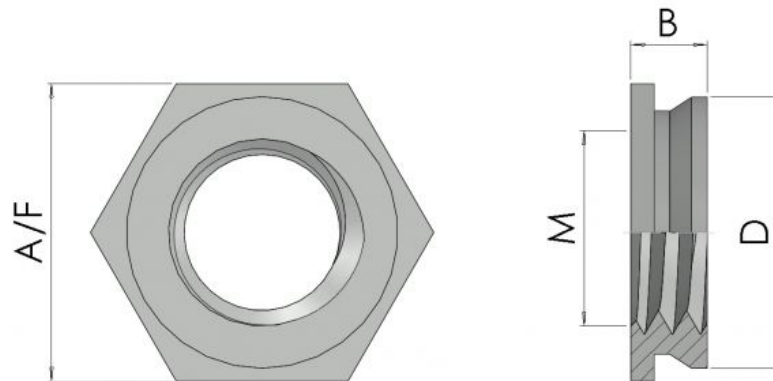

Series: 30304 Type: FN



## Self Clinch Flush Nuts

| Part No. | ThreadM | Min.Sheet | BodyA/F | BodyDepth B | LeadDiam. D | HoleSize |
|----------|---------|-----------|---------|-------------|-------------|----------|
| M 2-1    | M2      | 1.50      | 4.76    | 1.5         | 4.34        | 4.4      |
| M 2-2    | M2      | 2.30      | 4.76    | 2.3         | 4.34        | 4.4      |
| M 2.5-1  | M2.5    | 1.50      | 4.76    | 1.5         | 4.34        | 4.4      |
| M 2.5-2  | M2.5    | 2.30      | 4.76    | 2.3         | 4.34        | 4.4      |
| M 3-1    | M3      | 1.50      | 4.76    | 1.5         | 4.34        | 4.4      |
| M 3-2    | M3      | 2.30      | 4.76    | 2.3         | 4.34        | 4.4      |
| M3 L-1   | M3      | 1.50      | 6.40    | 1.5         | 5.35        | 5.4      |
| M3 L-2   | M3      | 2.30      | 6.40    | 2.3         | 5.35        | 5.4      |
| M3.5-1   | M3.5    | 1.50      | 6.40    | 1.5         | 5.35        | 5.4      |
| M3.5-2   | M3.5    | 2.30      | 6.40    | 2.3         | 5.35        | 5.4      |
| M4-1     | M4      | 1.50      | 7.94    | 1.5         | 7.34        | 7.4      |
| M4-2     | M4      | 2.30      | 7.94    | 2.3         | 7.34        | 7.4      |
| M5-1     | M5      | 1.50      | 8.73    | 1.5         | 7.90        | 7.9      |
| M5-2     | M5      | 2.30      | 8.73    | 2.3         | 7.90        | 7.9      |
| M6-3     | M6      | 3.20      | 9.53    | 3.1         | 8.71        | 8.75     |
| M6-4     | M6      | 4.00      | 9.53    | 3.9         | 8.71        | 8.75     |
| M6-5     | M6      | 4.75      | 9.53    | 4.7         | 8.71        | 8.75     |

Hex Flush nuts offer the opportunity of strong thread forms in sheet metal and alloys whilst providing a completely flush finish both sides of the sheet. This means that components can be mounted directly to the sheet without allowances having to be made for protrusions. The Hexagon head prevents torque out and provides high pull through resistance. The parts are squeezed into place using a press whilst supporting the reverse side. They are suitable for use in materials of Rockwell Hardness of B - 70 or less. Material: 303 Stainless Steel



Continued from previous page...

Series: 30304 Type: FN

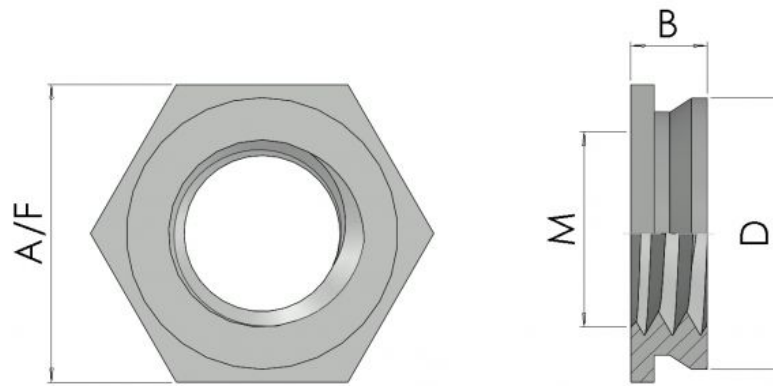

---

All information is given for guidance only and designers should satisfy themselves as to the suitability of the specification by requesting samples