

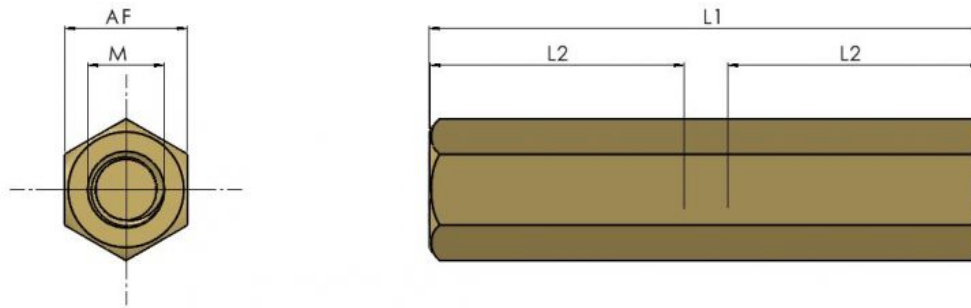

Series: 60203 Type: BS



Brass Blind Spacers

Part No.	Thread M	Body A/F	Length 1	Length 2
2040 18	M2	4	18	8
2040 20	M2	4	20	8
2040 25	M2	4	25	8
2040 30	M2	4	30	8
2550 15	M2.5	5	15	8
2550 18	M2.5	5	18	8
2550 20	M2.5	5	20	8
2550 25	M2.5	5	25	8
2550 30	M2.5	5	30	8
3050 25	M3	5	25	10
3050 30	M3	5	30	10
3050 35	M3	5	35	10
3050 40	M3	5	40	10
3050 45	M3	5	45	10
3050 50	M3	5	50	10
3050 55	M3	5	55	10
3050 60	M3	5	60	10
3055 25	M3	5.5	25	10
3055 30	M3	5.5	30	10
3055 35	M3	5.5	35	10
3055 40	M3	5.5	40	10
3055 45	M3	5.5	45	10
3055 50	M3	5.5	50	10
3055 55	M3	5.5	55	10
3055 60	M3	5.5	60	10
4070 25	M4	7	25	10
4070 30	M4	7	30	10
4070 35	M4	7	35	10
4070 40	M4	7	40	10
4070 45	M4	7	45	10



Continued from previous page...

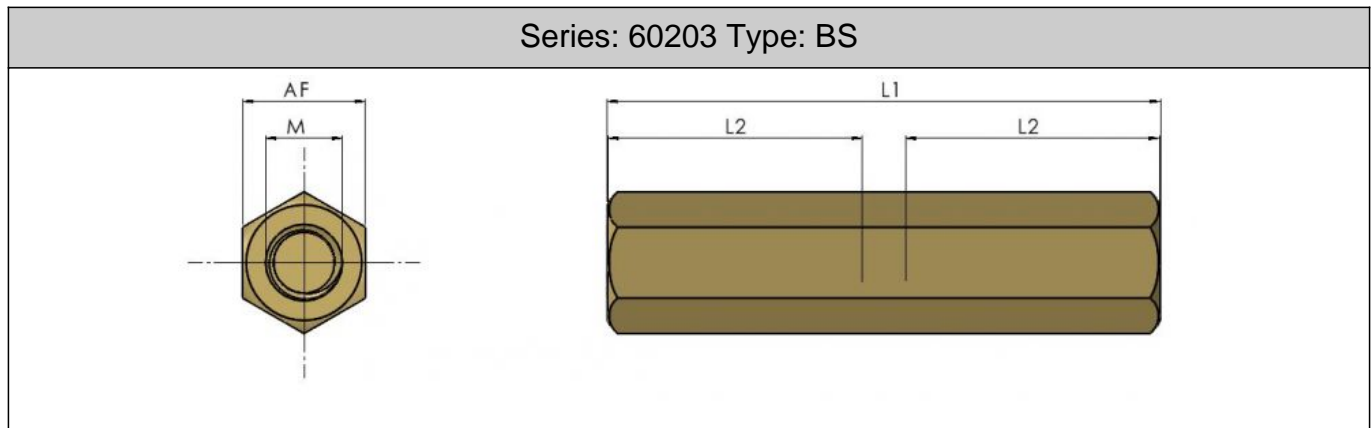

4070 50	M4	7	50	10
4070 55	M4	7	55	10
4070 60	M4	7	60	10
4070 70	M4	7	70	10
4070 80	M4	7	80	10
5080 25	M5	8	25	10
5080 30	M5	8	30	10
5080 35	M5	8	35	10
5080 40	M5	8	40	10
5080 45	M5	8	45	10
5080 50	M5	8	50	10
5080 55	M5	8	55	10
5080 60	M5	8	60	10
5080 70	M5	8	70	10
5080 80	M5	8	80	10

Blind Hexagon Spacers are available in various sizes. They are ideal for mounting electrical hardware and other components. Material & Finish: Brass Nickel (Stainless Steel available as special order) To Specify Use: Series No / Part No (eg 60203 3050 40)

All information is given for guidance only and designers should satisfy themselves as to the suitability of the specification by requesting samples