

## Imperial Round Push on Fix

Part No.	Shaft Size A	Dim B Inch	Dim C Inch
6218	1/16"	.380"	.008"
5883	3/32"	.380"	.008"
5897	1/8"	.380"	.008"
5928	5/32"	.450"	.008"
5920	3/16"	.450"	.008"
6324	7/32"	.450"	.008"
5873	1/4"	.600"	.010"
6326	9/32"	.600"	.010"
5821	5/16"	.600"	.010"
6332	11/32"	.725"	.012"
6020	3/8"	.725"	.012"
6331	13/32"	.725"	.012"
6216	7/16"	.983"	.016"
6143	1/2"	.983"	.016"
6325	17/32"	.983"	.016"
6185	5/8"	.983"	.016"
6322	3/4"	1.437"	.016"
6328	7/8"	1.500"	.018"
6329	1"	1.625"	.020"

Push on fixes provide a strong fixing on round shafts. Common applications are for retaining wheels or bearings but the possibilities are endless. They are also available with caps.



Continued from previous page...

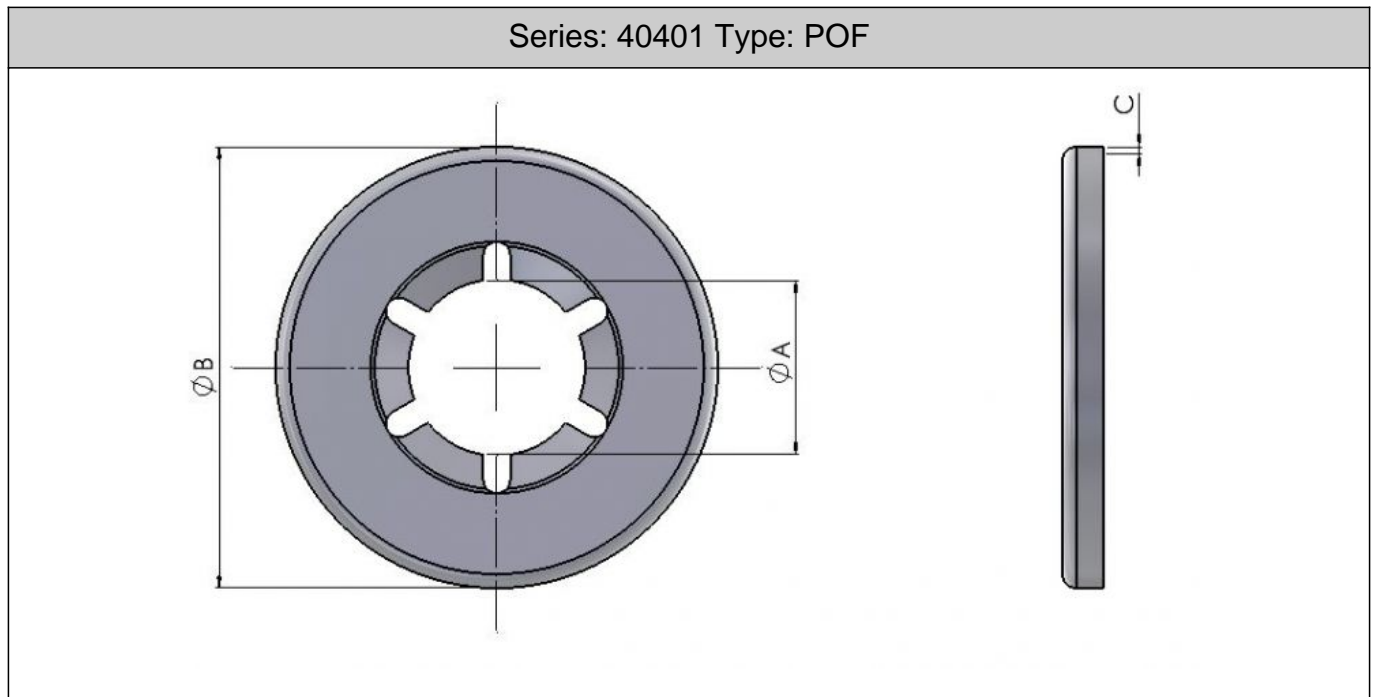

Material: C67S (stainless steel also available to order)  
Finish: Clear Laquer (Code 00) or Mechanical Zinc (Code 60)

---

**All information is given for guidance only and designers should satisfy themselves as to the suitability of the specification by requesting samples**