

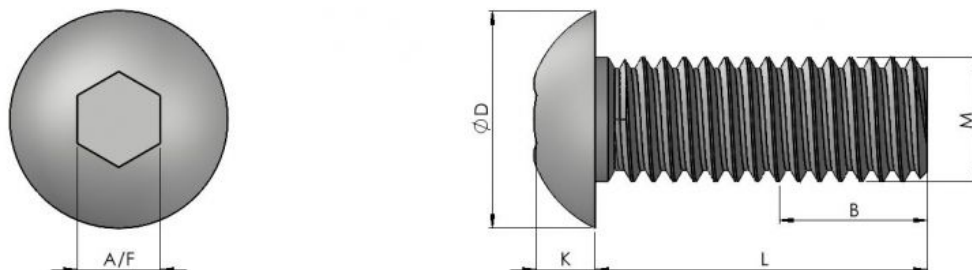

Series: 11704 Type: - ISO 7380-1



Hexagon Socket Button Head 10.9

Part No.	Thread	K	B When (L>B)	D	A/F
11704 M03**	M3	1.65	18.00	5.70	2.00
11704 M04**	M4	2.20	20.00	7.60	2.50
11704 M05**	M5	2.75	22.00	9.50	3.00
11704 M06**	M6	3.30	24.00	10.50	4.00
11704 M08**	M8	4.40	28.00	14.00	5.00
11704 M10**	M10	5.50	32.00	17.50	6.00
11704 M12**	M12	6.60	36.00	21.00	8.00

Legend	
*	Usually Available from Stock
**	Non-preferred (Possible Lead Times)
***	Special Order Only

Thread/Length	4	5	6	8	10	12	14	16	18	20	25	30	35	40	45	50	55	60	65	70	80	90	
M3	*	*	*	*	*	*	***	*	***	*	*	*	***	***	***	***	***	***	***	***	***	***	***
M4	***	*	*	*	*	*	***	*	***	*	*	*	***	***	***	***	***	***	***	***	***	***	***
M5	***	***	*	*	*	*	*	*	*	***	*	*	*	*	*	***	***	***	***	***	***	***	***
M6	***	***	*	*	*	*	*	*	*	*	*	*	*	*	*	*	*	*	***	***	***	***	***
M8	***	***	***	***	*	*	*	*	*	*	*	*	*	*	*	*	*	*	*	*	*	*	*
M10	***	***	***	***	***	***	***	*	***	*	*	*	*	*	*	*	*	*	***	*	***	***	***
M12	***	***	***	***	***	***	***	***	***	*	*	*	*	*	*	***	*	***	***	***	***	***	***

Material/Finish/Finish Code:

Steel - Self Colour - 00Steel - Zinc Plated - 60Stainless Steel A2 - Self Colour - SSStainless Steel A4 - Self Colour - A4

All information is given for guidance only and designers should satisfy themselves as to the suitability of the specification by requesting samples



Continued from previous page...

Series: 11704 Type: - ISO 7380-1

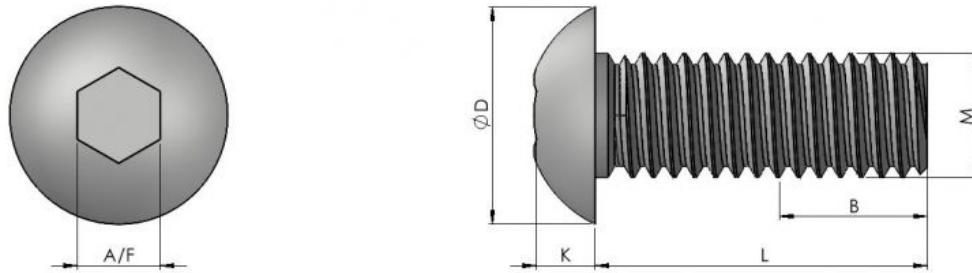

Part Number ID:

Part No/Thread Length/grade/Finish Code Eg: 11704 M0616 60: M6 x 16 Zinc Clear 10.9

All information is given for guidance only and designers should satisfy themselves as to the suitability of the specification by requesting samples