

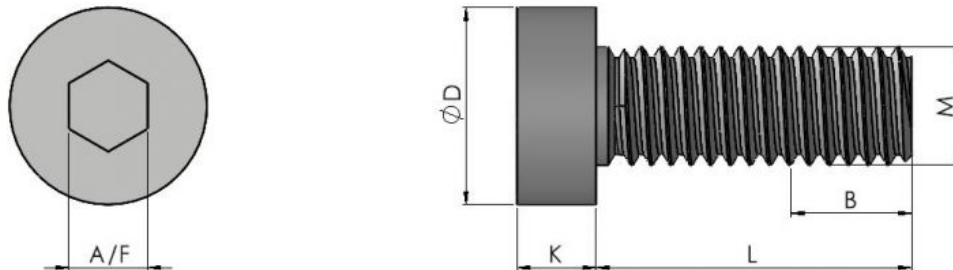

Series: 11705 Type: - DIN 7984



Hexagon Socket Low Profile Cap Head 8.8

Part No.	Thread	K	B When (L>B)	D	A/F
11705 M03**	M3	2.00	12.00	5.50	2.00
11705 M04**	M4	2.80	14.00	7.00	2.50
11705 M05**	M5	3.50	16.00	8.50	3.00
11705 M06**	M6	4.00	18.00	10.00	4.00
11705 M08**	M8	5.00	22.00	13.00	5.00
11705 M10**	M10	6.00	26.00	16.00	7.00
11705 M12**	M12	7.00	30.00	18.00	8.00
11705 M16**	M16	9.00	38.00	24.00	12.00

Legend	
*	Usually Available from Stock
**	Non-preferred (Possible Lead Times)
***	Special Order Only

Thread/Length	5	6	8	10	12	16	20	25	30	35	40	45	50	60	70	80
M3	*	*	*	*	*	*	*	***	***	***	***	***	***	***	***	***
M4	***	*	*	*	*	*	*	***	***	***	***	***	***	***	***	***
M5	***	***	*	*	*	*	*	*	*	***	***	***	***	***	***	***
M6	***	***	***	*	*	*	*	*	*	*	*	***	***	***	***	***
M8	***	***	***	***	*	*	*	*	*	*	*	*	*	***	***	***
M10	***	***	***	***	***	*	*	*	*	*	*	*	*	*	***	***
M12	***	***	***	***	***	***	*	*	*	*	*	*	*	*	***	***
M16	***	***	***	***	***	***	***	***	*	*	*	*	*	*	*	*



Continued from previous page...

Series: 11705 Type: - DIN 7984

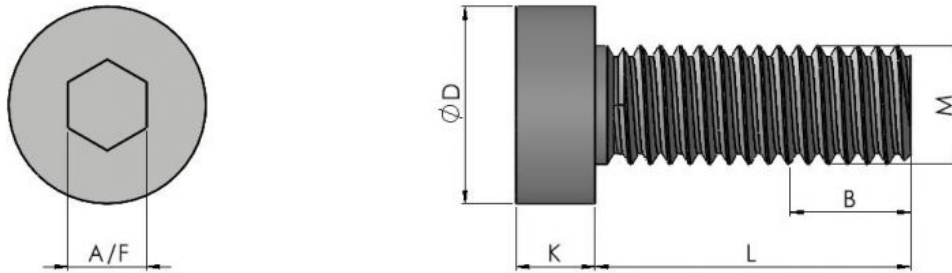

Material/Finish/Finish Code:

Steel - Self Colour - 00Steel - Zinc Plated - 60Stainless Steel A2 - Self Colour - SSStainless
Steel A4 - Self Colour - A4

Part Number ID:

Part No/Thread Length/grade/Finish CodeEg: 11705 M0616 60: M6 x 16 Zinc Clear 10.9

All information is given for guidance only and designers should satisfy themselves as to the suitability of the specification by requesting samples